

HYDROSHIELD TECHNOLOGY™



DOOR SYSTEM INSTALLATION INSTRUCTIONS

The Door Systems listed below can be installed by following these instructions.



Single Doors

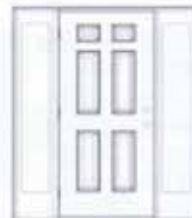

Single & Double
Continuous
Sidelite Units



French &
Patio Units

Installation Checklist

- Clean, dry, level, and solid subfloor
- Three beads of caulk under the sill
- Ensure consistent margins
- Adjust the sill cap or door bottom
- Install corner pads
- Caulk corner of sill and jamb
- Position & Install astragal (French units)
- Caulk around door unit and use flashing



A Member Solution by

GM Wood Products

531 Clay Street, PO Box 295, Newryga, MI 49337 | 800.530.9211

DOOR SYSTEM INSTALLATION INSTRUCTIONS

PREPARING THE ROUGH OPENING

- Are the walls straight?
- Are the studs plumb and level?
- Is the subfloor clean, dry, level and solid?



If you are using a height plate to bring the sill up to the level of the finished floor covering:

- Be sure that it is at least as wide as the sill and as long as the rough opening.



Be sure to caulk thoroughly under and around the height plate.



PRE-CAULKING SUBFLOOR FOR SILL



Put three heavy beads (1/2" wide) of silicone caulk on the subfloor or height plate as shown. Put enough caulk at the sides to completely cover the bottom of the side jamb.



Pivot door unit directly into position.



POSITION UNIT IN ROUGH OPENING

Secure fasteners through jambs as shown, just above the hinge positions on the hinge jamb. Do not fully seat.



Single units:
Fasten Hinge Jamb

Sidelite Units:
Fasten Sidelite Jamb to Hinge Jamb

French & Patio Units:
Fasten Jamb on fixed or passive side of door

Assure that back side of brickmold is up against exterior sheathing.



Do not fully seat. Leave the fasteners sticking out a little for final adjustment.

SHIM AND SECURE HINGE JAMB

- Check hinge jamb for plumb and true with a 6-foot level.
- If necessary, on hinge jamb only: Place one shim behind each hinge between the hinge jamb and the wall stud. (Additional shims can be used if necessary)



- Drive a fastener through each shim and remove excess shim.



ENSURE CONSISTENT MARGINS

- Measure the rough opening width.
- Adjust the frame so it is flush with the face of the door.
- Stand the frame unit into the opening and plumb with the wall. There should be approximately 1/2" clearance all the way around the unit. Wedge shims on the bottom at each corner to center and stabilize the unit. Continue placing shims up each side of the unit as shown. Make sure the jambs remain square and vertical as you go. Min. five (5) shims (3 on the bottom every 2') for each side are recommended.



- Check the weatherstrip contact for even compression all around the door.

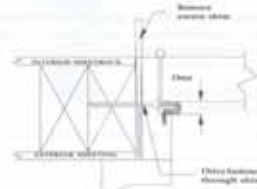

- Drive fasteners through jambs at locations of top and bottom shims, then remove excess shims.

APPLYING HINGES AND LOCKSET HARDWARE

- Remove the top screw from each hinge and replace with a #10 x 2-1/2" screw. These screws will run through hinge jamb and into the wall stud, preventing door sag.
- Install lockset hardware.
- With door closed, shim behind latch area to maintain proper margins.
- Attach the strike plate with two #10 x 2-1/2" screws through the shim and into the wall stud. Remove excess shim.



FASTENING HEADER

- Fasten through thick part of header. Use shim at each location indicated (X) to maintain proper margin.

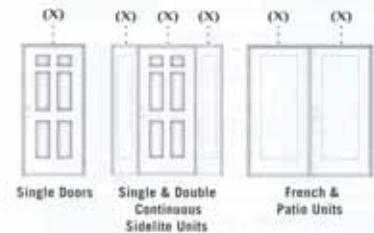

Single Doors

Single & Double Continuous Sidelite Units

French & Patio Units

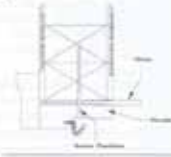

DOOR SYSTEM INSTALLATION INSTRUCTIONS

ENSURE CONSISTENT MARGINS

- Measure the rough opening width.
- Adjust the frame so it is flush with the face of the door.
- Stand the frame unit into the opening and plumb with the wall. There should be approximately 1/2" clearance all the way around the unit. Wedge shims on the bottom at each corner to center and stabilize the unit. Continue placing shims up each side of the unit as shown. Make sure the jambs remain square and vertical as you go. Min. five (5) shims (3 on the bottom every 2') for each side are recommended.



- Check the weatherstrip contact for even compression all around the door.

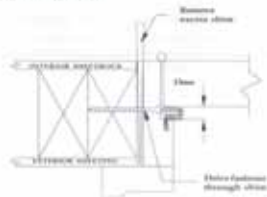

- Drive fasteners through jambs at locations of top and bottom shims, then remove excess shims.

APPLYING HINGES AND LOCKSET HARDWARE

- Remove the top screw from each hinge and replace with a #10 x 2-1/2" screw. These screws will run through hinge jamb and into the wall stud, preventing door sag.
- Install lockset hardware.
- With door closed, shim behind latch area to maintain proper margins.
- Attach the strike plate with two #10 x 2-1/2" screws through the shim and into the wall stud. Remove excess shim.



FASTENING HEADER

- Fasten through thick part of header. Use shim at each location indicated (X) to maintain proper margin.

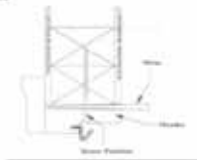
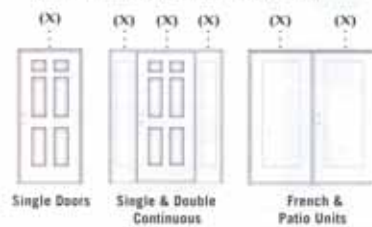

ADJUST SILL AND CHECK CORNER PADS

- If necessary, adjust the sill cap to ensure consistent spacing between panel and cap.
- Verify proper installation of corner pads. The raised fin of the corner pad needs to be tucked behind the weatherstrip as shown. (Both strike and hinge sides.)
- The corner pad must also contact the top surface of the sill cap.



CAULKING THE SILL

- Caulk must be applied to the intersection of the aluminum sill extrusion and the jamb.
- Seal front bottom edge of sill.
- Caulk around the intersection of the mull and the door sill.
- If a sill extender is installed, apply a bead of caulk where the extender meets the sill.



ASTRAGAL POSITIONING (FRENCH)

- Close the passive door to verify that it is in the desired position.
- Push bolt pins to contact header and sill, then mark positions for retainer holes.
- Complete installation and positioning of astragal according to Plastpro's "Field Installation Instructions" provided with the French unit.
- The strikes should be adjusted as far in the direction of door closure as possible to assure that the strikes pull the door up to the weatherstrip tightly.

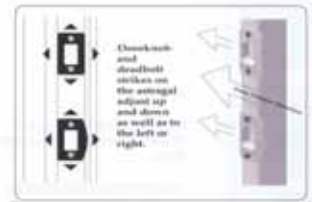

WEATHERPROOFING

- Caulk around the entire unit on weather-exposed side between brickmold and siding or sheathing.
- Caulk at joint of brickmold and jamb.
- Install sheet metal flashing, or equivalent moisture barrier above the brickmold on the exterior of the house.



DISCLAIMER

The instructions contained herein are general suggestions. The customer accepts the instructions "As Is" and uses them solely at its own risk. Plastpro makes no warranties, express or implied, as to accuracy, reliability, usability, merchantability, or fitness for a particular purpose. Under no circumstances shall Plastpro be liable for any damages resulting from the use, misuse, or inability to use the instructions.

PF FRAME STAINING INSTRUCTIONS

PF FRAME PAINTING INSTRUCTIONS

MATERIALS NEEDED

- Hand Saw
- Hammer
- Level
- Measuring Tape
- Nails
- Shims
- Goggles



STEP 1:

Screw or staple head and sides of frame together.

STEP 2:

Install frame into opening, use shims and a level to square up door frame.

Anchor frame to studs with wood screws or nails.

STEP 3:

Install brick moulding on the exterior side. Caulk between brick moulding and siding to provide a proper seal. Use an interior moulding for the inside trim.

Your frame is now ready for door installation and painting.

MATERIALS NEEDED

- A. Lint-free cloth
- B. Mineral Spirits
- C. Rubber gloves
- D. Masking tape
- E. 3"- 4" soft bristle brush
- F. Gel Stain, such as ZAR™ Stain, Wood Kote®, Jeld Stain, Minwax® Gel Stain, etc.



STEP 1: SURFACE PREPARATION

1. Lay jamb horizontally on saw horses or a table.
2. Remove all the hardware and mask off anything you don't want stained.
3. DO NOT SAND GRAINED PF FRAMES

4. Wipe the jamb with mineral spirits or acetone to clean any dust or residue from the surface. Allow jamb surface to dry completely before applying stain.



STEP 2: STAIN APPLICATION

FIRST COAT

1. Starting at the center of the jamb, stain one to two panels at a time. Apply stain with a 3" to 4" soft bristle brush, or rag. Apply enough stain to fill the jamb grain. (Refer to the jamb staining diagram.)

2. With a clean, lint-free 24 x 24 inch cloth, softly wipe the surface until you reach your desired tone. **TIP:** When the rag becomes saturated with stain, re-fold to work with a less-saturated section. Be sure to use the same rag for the whole jamb.

3. After all the stain is brushed evenly you may add finishing touches by using a small 1" to 2" brush or cotton swabs.

SECOND COAT (if desired)
ALLOW THE JAMB TO DRY FOR AT LEAST 48 HRS. BETWEEN COATS.
Repeat as above.



STEP 3: PROTECTIVE TOP COAT

Application of polyurethane top coat with UV inhibitors like ZAR™ Exterior polyurethane, Wood Kote® Flagship UV, or Minwax® Fast Drying Polyurethane for exterior applications

1. After stain has completely dried (48 hours), mix the top coat well and apply evenly using a clean dry 2" soft bristle brush or 3" foam brush. Be sure to stop when the grain changes direction.
2. Apply two or three coats of finish, allowing at least 24 hours of drying time between each application.

MATERIALS NEEDED

- Hand Saw
- Hammer
- Level
- Measuring Tape
- Nails
- Shims
- Goggles



STEP 1:

Screw or staple head and sides of frame together.

STEP 2:

Install frame into opening, use shims and a level to square up door frame.

Anchor frame to studs with wood screws or nails.

STEP 3:

Install brick moulding on the exterior side. Caulk between brick moulding and siding to provide a proper seal. Use an interior moulding for the inside trim.

Your frame is now ready for door installation and painting.

MATERIALS NEEDED

- A. Lint-free cloth
- B. Mineral Spirits
- C. Rubber gloves
- D. Masking tape
- E. 4" bristle brush
- F. Scotch Brite Pad (Fine) or 320-400 grit sandpaper
- G. For Water-based application: Acrylic-based primer / acrylic latex-based exterior grade paint.

MATERIALS NEEDED



STEP 1: SURFACE PREPARATION

1. Lay jamb horizontally on saw horses or a table.
2. Remove all the hardware and mask off anything you don't want painted.
3. Lightly scuff sand the surface with Scotch Brite pad or fine sandpaper.
4. Wipe the jamb with mineral spirits to clean any dust or residue from the surface. Allow acetone to dry from the surface before applying paint. Do not use hydro-carbon based solvents to clean the surface as such products may leave a residue.



STEP 2: PAINTING

1. Apply exterior grade paint with 4" brush beginning with the panels.
2. It is common practice to paint both sides the same color as the exterior side of the jamb. If applying a second coat, follow the manufacturer's instructions for drying time between coats.

CAUTION

1. When using stains, mineral spirits, paints, or other hazardous materials, always read and follow the manufacturer's instructions. Plastpro, Inc. makes no representations as to the proper use of other manufacturers' products.
2. When working with paints or solvents, make sure the working area is well ventilated.
3. Keep away from heat and flame as materials may be combustible.
4. Paints or solvents may cause skin and eye irritation. Avoid contact with skin and eyes.
5. Keep out of reach of children.

NOTICE: SAFETY PRECAUTIONS:
Paints & wall-mounted PF Frames will be affected by increased wind weathering from salt, moisture, and air pollutants. It is recommended minimal maintenance be performed to the exterior appearance every 1000 hours.